

ALDRIDGE PRESCRIBED BURN (controlled burn) 2023 09 23

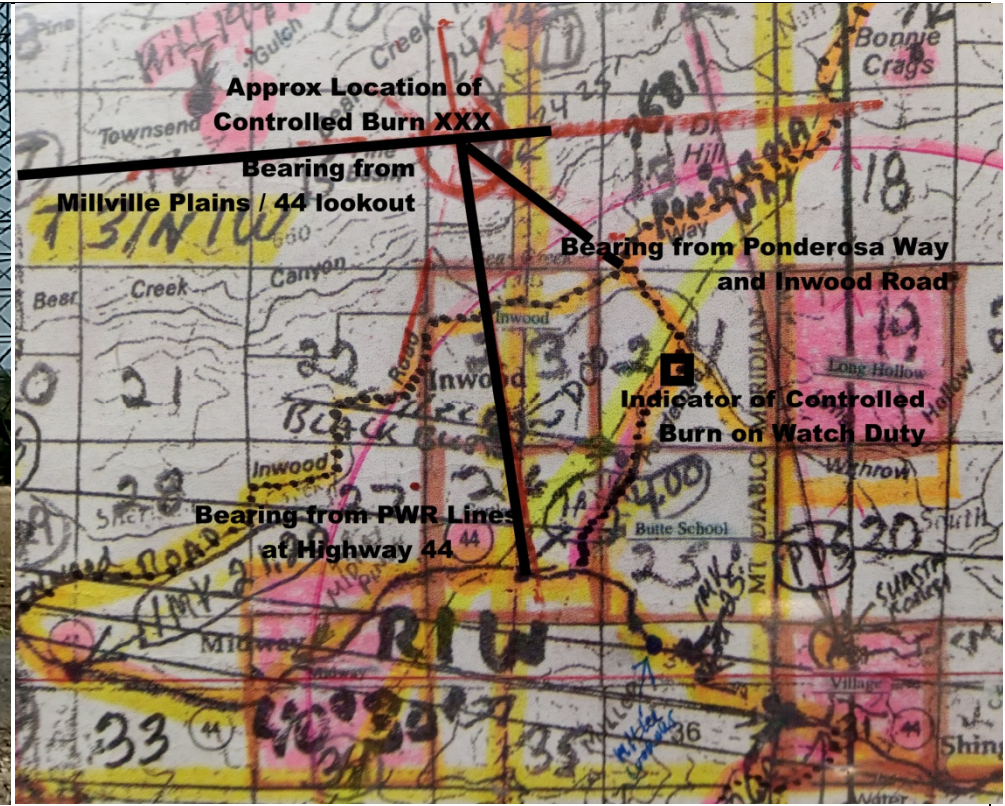

2023 09 22 Aldridge Prescribed Burn:

Bearing was taken from Millville Plains 44 lookout and plotted to Map. Another Bearing was taken from Highway 44 and Power Lines and plotted to map. The last bearing was taken from Ponderosa Way and Inwood Road and plotted to map. Where the lines intersect is the approx location of the prescribed Burn. Note: that the Indicator of "Aldridge Prescribed Burn" on the Watch Duty Map is just south of Withrow and Ponderosa Way and is not where the actual incident is located. **Later**, WATCH DUTY added coloration to show the location of the actual incident (see below). This same situation exists on the Fire Maps – i.e., the indicator may not be where the actual incident is located.

ALDRIDGE PRESCRIBED BURN (controlled burn) 2023 09 23

